

UI Navigation



UI navigation is easily performed using the navigation keys located above the Callers List key. The Left and Right navigation keys are used to switch to the different screens and the Up and Down keys are used to highlight and scroll through the different lines/calls on the respective screen. The figure below provides a visual representation of the different screens and the UI behavior when a navigation key is pressed.

Note:

The Detailed-View Call Screen is only accessible when at least one call is in a ringing or connected state. Moreover, the Multi-View Call Screen is only accessible when more than one call is a ringing or connected state.

Home Screen

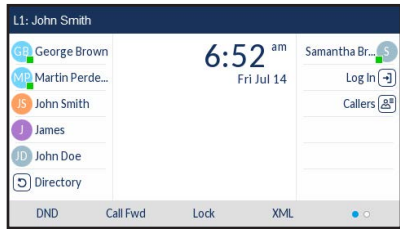

Line Selection Screen

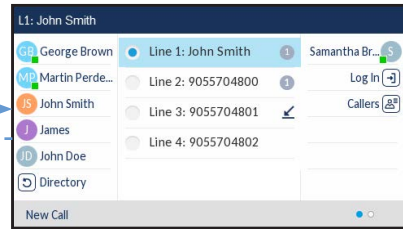

Multi-View Call Screen

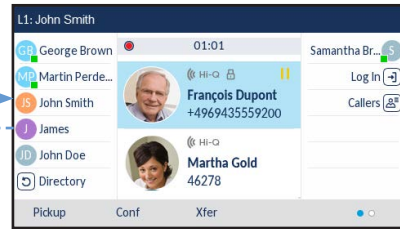

Detailed-View Call Screen

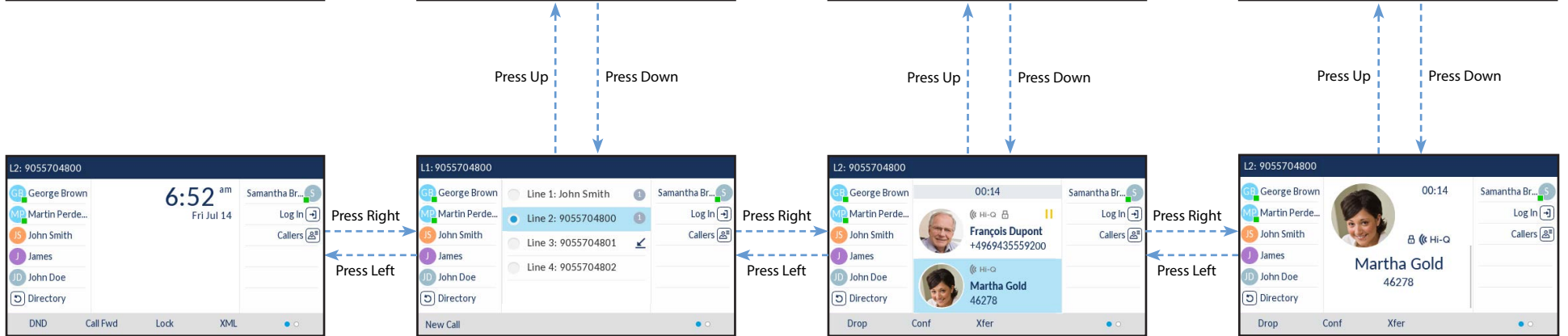

Advanced Call Handling

The 6869i IP phone provides simple and convenient methods for transferring calls and establishing conference calls.

Note:

Transferring and conferencing can be initiated in both the Multi-View and Detailed-View Call Screens.

Call Transferring

1. Ensure you are on active call with the party you wish to transfer.
2. If you are already connected to the transfer recipient, press the **Up** or **Down** navigation keys to highlight the recipient and press the **Xfer** softkey to complete the call transfer.

OR

If you are not connected to the transfer recipient, press the **Xfer** softkey, enter the recipient's number and press the **Dial** softkey. At any time, press the **Xfer** softkey again to complete the call transfer.

3-Way Conferencing

1. Ensure you are on active call with one of the parties with whom you wish to create a conference.
2. If you are already connected to the party you wish to conference in, press the **Up** or **Down** navigation keys to highlight the conference target and press the **Conf** softkey to complete the 3-way conference.

OR

If you are not connected to the party you wish to conference in, press the **Conf** softkey, enter the conference target's number and press the **Dial** softkey. At any time, press the **Conf** softkey again to complete the 3-way conference.

Note:

If the 3-way conference is successful, icons will be displayed in the call status indicator area of both conference participants.

Other Features

Using the Presence Key

The Presence key is used to access the contact information screens, which provide detailed information about a respective Busy Lamp Field (BLF) or Speed Dial contact.

1. On the Home Screen, press the key.
2. Press a top softkey that is configured with BLF or Speed Dial functionality. The contact information screen will be displayed.

Note:

To switch to another contact, simply press the desired BLF or Speed Dial softkey.

3. Press the **Select** key to place a call using the contact's default phone number. If you would like to place a call to a different phone number attached to the contact (if applicable), highlight the desired phone number using the **Up** or **Down** navigation keys, and press the **Select** key.

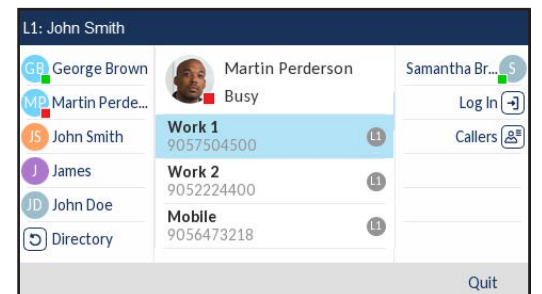

Using the Directory

1. Press the softkey configured with Directory functionality to access the Directory.
2. Scroll through the list by pressing the **Up** or **Down** navigation keys or enter characters using the keypad to use the search feature.
3. When the desired entry is highlighted, press the **Select** key to place a call using the entry's default phone number. If you would like to place a call to a different phone number attached to the entry (if applicable), press the **Right** navigation key, highlight the desired phone number using the **Up** or **Down** navigation keys, and press the **Select** key.

Using the Callers List

1. Press the key to access the Callers List.
2. Scroll through the list by pressing the **Up** or **Down** navigation keys. If you would like to view additional entry details, press the **Right** navigation key.
3. Press the **Select** key to place a call to the respective entry.